



5 May 2017

To: Users of The Broker's Workstation and/or The Underwriter's Workstation

Dear Valued Client:

Re: The Broker's Workstation and The Underwriter's Workstation – Important Releases and Changes

Custom Software Solutions Inc. (CSSI) is pleased to announce the release of the following enhancements and newest features to **The Broker's Workstation (TBW)** and **The Underwriter's Workstation (TUW)**:

Contents

1. [Water Plus and Limited Sewer Backup Coverage for Peace Hills](#) – Effective April 1, 2017 for new business and renewals, Water Plus and Limited Sewer Backup endorsements are available in TBW/TUW for brokers doing business with Peace Hills Insurance.

1. Water Plus and Limited Sewer Backup Coverage for Peace Hills

Effective April 1, 2017 for new business and renewals, Water Plus and Limited Sewer Backup endorsements are available in TBW/TUW for brokers doing business with Peace Hills Insurance. Eligibility, rates, and deductibles for the Water Plus and Limited Sewer Backup endorsements are dependent upon the location of the risk.

The **Water Plus Endorsement** is available in applicable areas for the following risk types/forms: *Homeowners, Condominium Unit Owners, Tenant Packages (Form 100 and 200), and Rented Dwelling Package Comprehensive (Form 500)*.

Water Plus is a comprehensive product that covers *Freshwater Flooding* and *Sewer Backup*.

- This endorsement includes flood caused by the rising of, breaking out, or overflow of inland bodies of water, surface water, sewer backup, and instances where more than one cause of loss insured by this form occurs in the same event. Losses caused by ground water may also be insured.
- The following are not insured: flood caused by the rising of, breaking out, or overflow of tidal bodies of water, tsunami, seiche, storm surge, waves, or tidal waves (including spray).
- Rating for the Water Plus endorsement is done by geo code (latitude/longitude) when available, and otherwise by postal code. Additional variables used in rating include year built, occupancy type, number of stories, if basement exists and percentage finished, mainline backwater valve, septic system, value of the dwellings and/or personal property (contents), and deductible.

The **Limited Sewer Backup Endorsement** is available in applicable areas on all package types, with the exception of the following risk types/forms: *Seasonal Dwellings* (Form 600), *Seasonal Residence* (Form 410), and *Mobile Home* (Form 300).

- Please note, because the Water Plus endorsement includes Sewer Backup, the Limited Sewer Backup endorsement cannot be added to an IntelliQuote at the same time as the Water Plus endorsement.

To add the Water Plus endorsement to a new or existing IntelliQuote, first please confirm the full risk address (including postal code) has been entered correctly and validated on the **Legal Location** tab in **Coverage Item Properties** (see Figure 1.1).

- Without input of the full risk address, the Water Plus endorsement will not be available to add to the IQ.

(Figure 1.1)

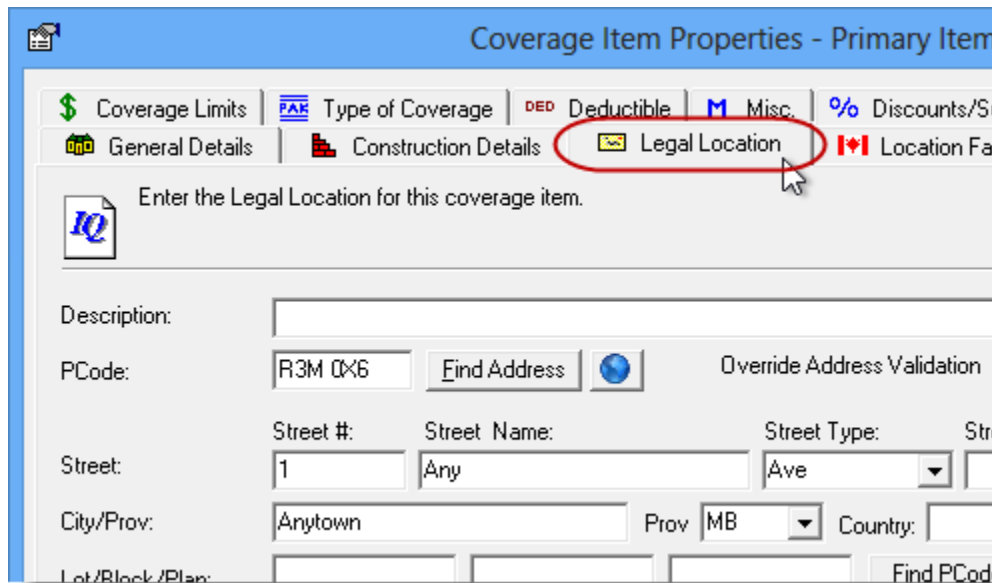

Then, click the **Coverage Items** button on the IQ toolbar (see Figure 1.2).

(Figure 1.2)

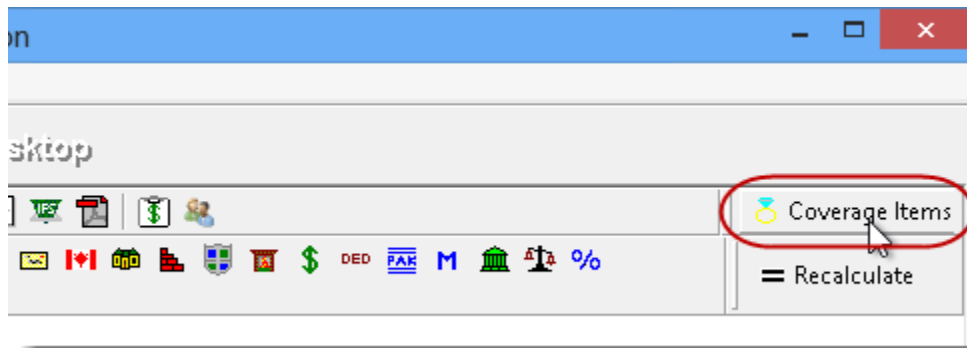

Next, in the **Optional Coverages** dialog, double-click **Water Coverage** on the **Endorsements/Extensions** tab (see Figure 1.3).

- The Water Coverage option will not be available in Optional Coverages for Peace Hills Insurance if the address/postal code entered for the property is not eligible for the Water Plus endorsement.

(Figure 1.3)

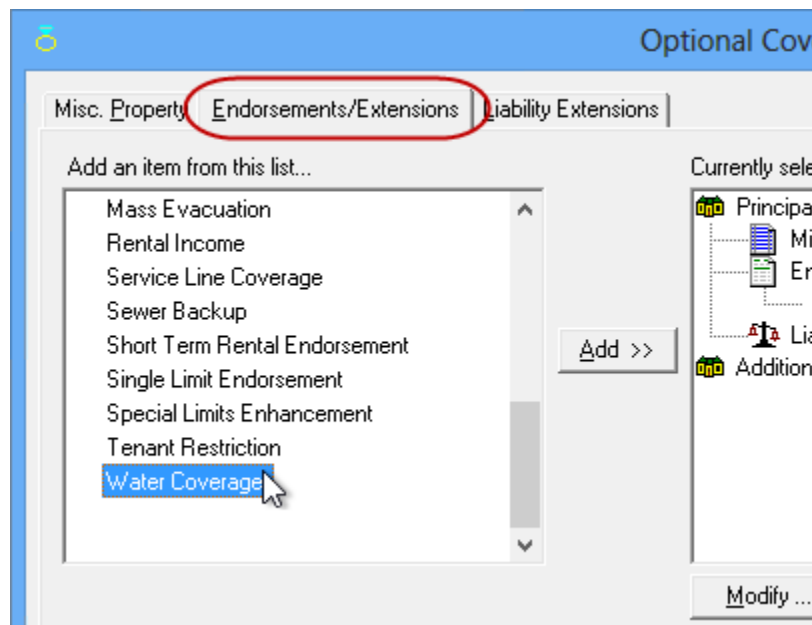

Enter applicable details with the help of the **Coverage Item Wizard** that displays (see Figure 1.4), using the **Next** button to move from one screen to the following, and then click **Finish**.

- If the ability to select a deductible is available, note that the endorsement deductible cannot be lower than the policy deductible.

(Figure 1.4)

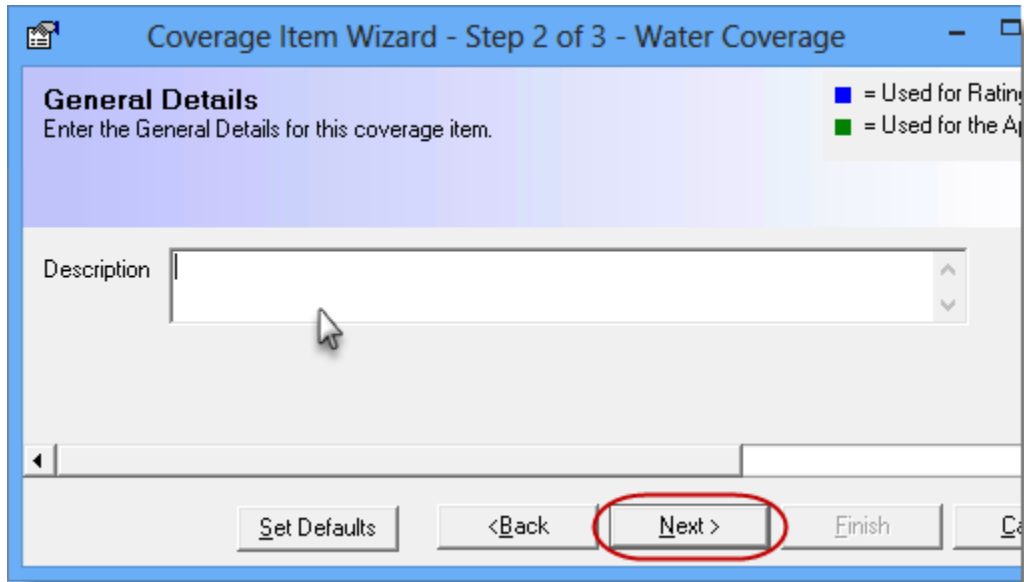

If the Limited Sewer Backup endorsement is to be added to the IQ instead, select and add the **Sewer Backup** endorsement in **Optional Coverages** (see Figure 1.5).

- Note that the deductible for Sewer Backup cannot be lower than the policy deductible.

(Figure 1.5)

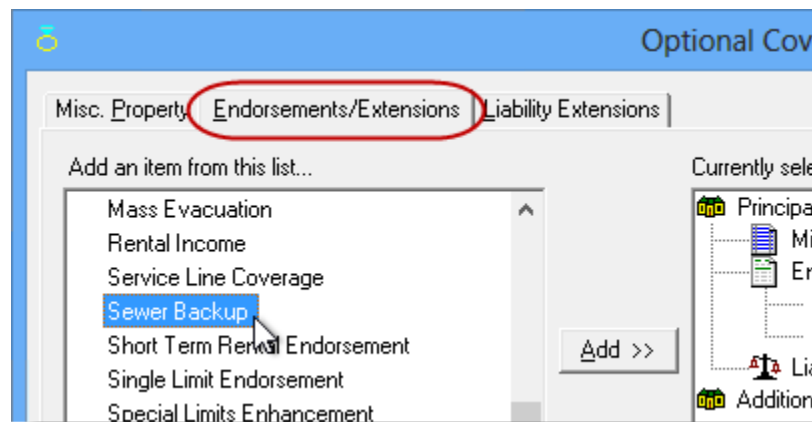

Once added in Optional Coverages, endorsements will display in the **Currently selected items** area (see Figure 1.6).

(Figure 1.6)

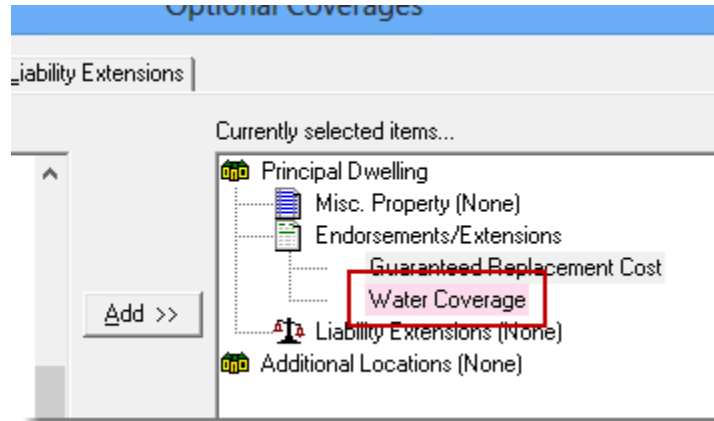

After you have completed or modified the IntelliQuote in the usual manner, remember to click the **Recalculate** button on the IQ toolbar to update the IQ with any changes (see Figure 1.7). Any endorsement that has been added to the IQ, along with applicable premium details, will display on the **Summary Report** tab.

(Figure 1.7)

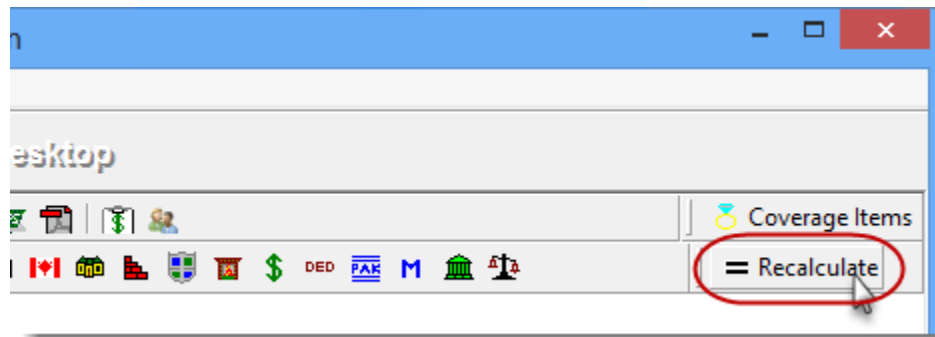

Please remember, the Water Plus and Limited Sewer Backup endorsements cannot both be added to a new or existing IQ for Peace Hills Insurance, as Sewer Backup is included in the Water Plus endorsement. If you attempt to add Sewer Backup to the IQ when the Water Plus coverage has already been added, you will be reminded that these cannot be added at the same time (see Figure 1.8).

(Figure 1.8)



[Return to Contents](#)

Please share this information with the appropriate TBW and TUW users in your office(s). Once you have reviewed this document, if you have any questions regarding these features or need further assistance in their usage, please contact our Client Services Team at clientservices@cssionline.com (email) or 1-888-291-3588 (toll-free telephone).

Thank you for using The Broker's Workstation and The Underwriter's Workstation.

Yours sincerely,

Custom Software Solutions Inc.



To unsubscribe from our email notifications and updates, please contact us at info@cssionline.com or reply to this email.